

Site Appraisal

Class Outline

1. Method
2. Site Survey

Method

1. Determine Clint's requirements:
 1. Project Program: Activities
 2. Appearance and Character
 3. Budget: Capital & maintenance costs
 4. Schedule

2. Commission a property plan

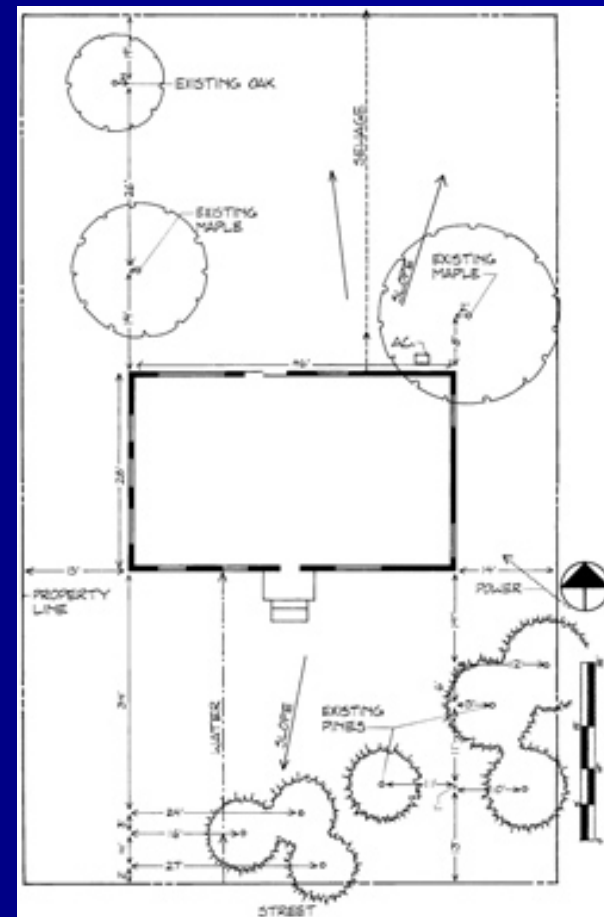

3. Survey the site and inventory its resources and problems

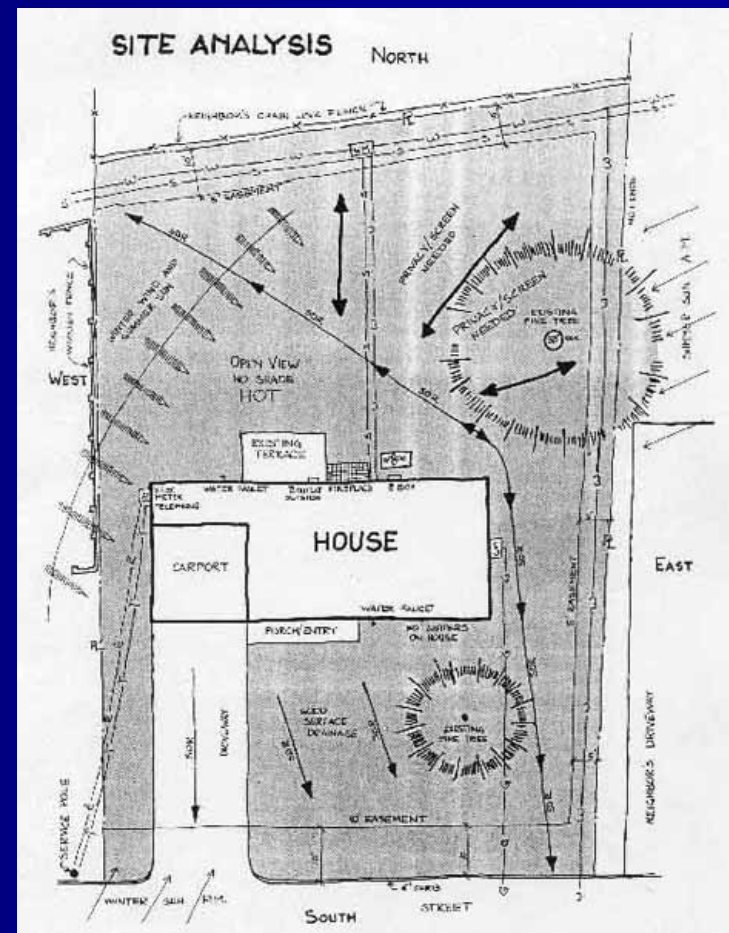

4. Analyze site resources and problems

5. Draw up recommendations and guidelines

6. Diagram alternative concepts and compare for impact

7. Draw up preliminary plan; get approval and draw final plan

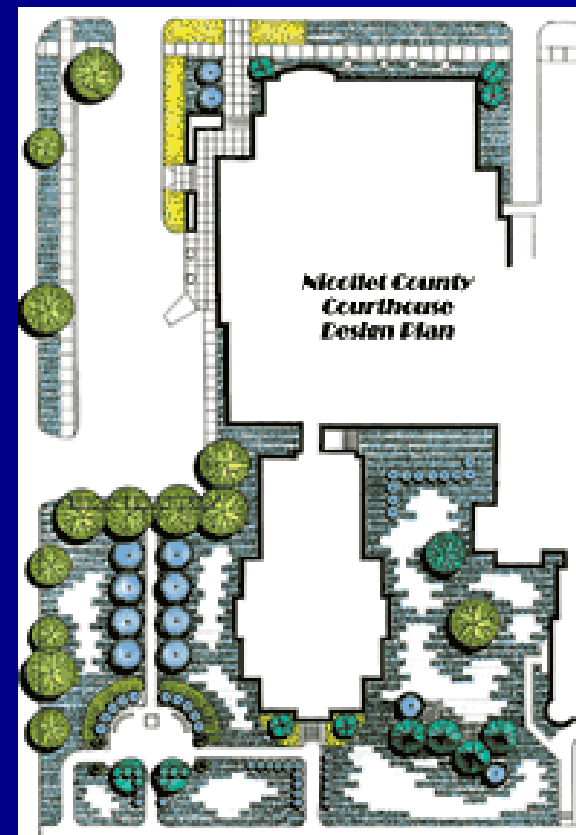



Site Survey

■ **Climate:**

- Temperature,
- sun path & shade,
- glare,
- precipitation,
- relative humidity,
- salt spray,
- pollution,
- winds.

■ **Topography:**

- aspect,
- exposure,
- microclimate,
- slope steepness,
- watershed.

- **Geology (surficial):**

- erosion,
- landslides,
- sand movement; (bedrock): type & depth.

- **Hydrology:** (surface water):

- quality, floods,

- irrigation,

- cost of supply. (Ground water): depth, quality and quantity, wells.

■ Soils:

- Depth,
- drainage,
- hardpans,
- texture and structure,
- stoniness,
- fill,
- PH,
- fertility.

■ Ecology:

■ flora & fauna:

- dominants,
- associations,
- distribution,
- pests & disease,
- plants as indication of climate,
- soil &
- moisture.

■ **Man:**

- land uses,
- surroundings,
- infrastructure,
- social &
- economic factors.

■ **Visual & spatial factors:**

- panoramas,
- view in & out,
- landmarks,
- visual character,
- visual quality,
- visual pollution,
- sense of place,
- unity,
- spatial enclosure,
- outdoor rooms,
- sequence.